

HBC2/3/4XX

Exploded parts diagram

Image shown is the HBC4XX With Upstand

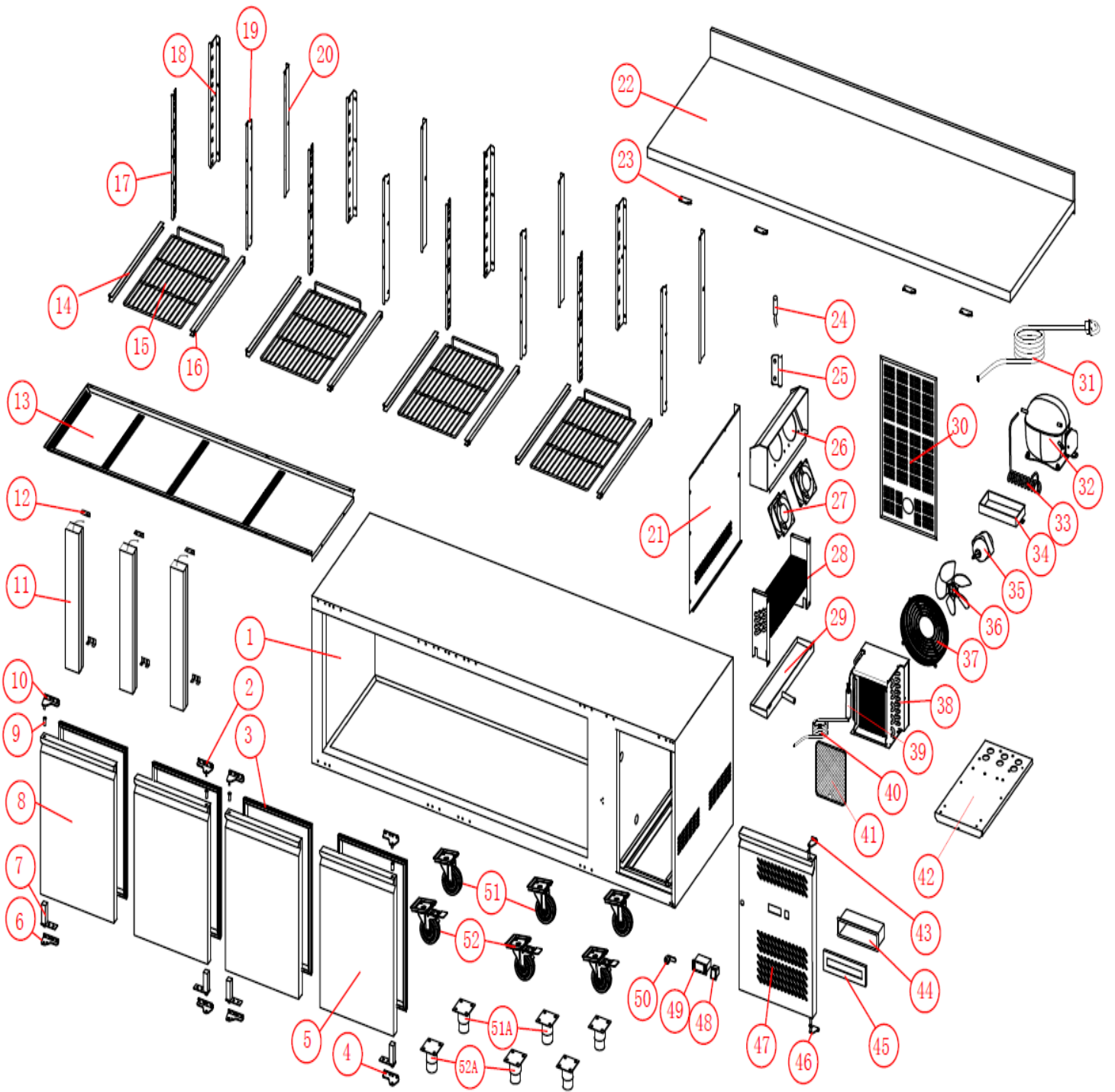





Part Number	Number	Description	Qty
***	1	Cabinet	1
X1-HINGE13	2	RH Upper Hinge (HBC4XX)	2
X1-HINGE13	2	RH Upper Hinge (HBC3XX)	2
X1-HINGE13	2	RH Upper Hinge (HBC2XX)	1
B1-GASKET27	3	Door Gasket (HBC4XX)	4
B1-GASKET27	3	Door Gasket (HBC3XX)	3
B1-GASKET27	3	Door Gasket (HBC2XX)	2
X1-HINGE14	4	RH Bottom Hinge (HBC4XX)	2
X1-HINGE14	4	RH Bottom Hinge (HBC3XX)	2
X1-HINGE14	4	RH Bottom Hinge (HBC2XX)	1
X1-DOOR09N	5	Door (right) (HBC4XX) *Please check cabinet Mark*	2
X1-DOOR09N	5	Door (right) (HBC3XX) *Please check cabinet Mark*	2
X1-DOOR09N	5	Door (right) (HBC2XX) *Please check cabinet Mark*	1
X1-HINGE15	6	LH Bottom Hinge (HBC4XX)	2
X1-HINGE15	6	LH Bottom Hinge (HBC3XX)	1
X1-HINGE15	6	LH Bottom Hinge (HBC2XX)	1
***	7	Spring Hinge (HBC4XX)	4
***	7	Spring Hinge (HBC3XX)	3
***	7	Spring Hinge (HBC2XX)	2
X1-DOOR08N	8	Door (left) (HBC4XX) *Please check cabinet Mark*	2
X1-DOOR08N	8	Door (left) (HBC3XX) *Please check cabinet Mark*	1
X1-DOOR08N	8	Door (left) (HBC2XX) *Please check cabinet Mark*	1
K8-AXISSLEEVE	9	Door Bush (HBC4XX)	8
K8-AXISSLEEVE	9	Door Bush (HBC3XX)	6
K8-AXISSLEEVE	9	Door Bush (HBC2XX)	4
X1-HINGE16	10	LH Upper Hinge (HBC4XX)	2
X1-HINGE16	10	LH Upper Hinge (HBC3XX)	2
X1-HINGE16	10	LH Upper Hinge (HBC2XX)	1
***	11	Mullion (HBC4XX)	3
***	11	Mullion (HBC3XX)	2
***	11	Mullion (HBC2XX)	1
***	12	Mullion Connection (HBC4XX)	6
***	12	Mullion Connection (HBC3XX)	4
***	12	Mullion Connection (HBC2XX)	2
***	13	Air Distribution Panel	1
K8-GUIDE02	14	Left Shelf Guide (HBC4XX)	4
K8-GUIDE02	14	Left Shelf Guide (HBC3XX)	3
K8-GUIDE02	14	Left Shelf Guide (HBC2XX)	2
X1-SHELF04	15	Shelf (HBC4XX)	4
X1-SHELF04	15	Shelf (HBC3XX)	3
X1-SHELF04	15	Shelf (HBC2XX)	2
K8-GUIDE03	16	Right Shelf Guide (HBC4XX)	4
K8-GUIDE03	16	Right Shelf Guide (HBC3XX)	3

K8-GUIDE03	16	Right Shelf Guide (HBC2XX)	2
***	17	Ladder Rack (left) (HBC4XX)	4
***	17	Ladder Rack (left) (HBC3XX)	3
***	17	Ladder Rack (left) (HBC2XX)	2
***	18	Rear Ladder Rack (left) (HBC4XX)	4
***	18	Rear Ladder Rack (left) (HBC3XX)	3
***	18	Rear Ladder Rack (left) (HBC2XX)	2
***	19	Ladder Rack (right) (HBC4XX)	4
***	19	Ladder Rack (right) (HBC3XX)	3
***	19	Ladder Rack (right) (HBC2XX)	2
***	20	Rear Ladder Rack (right) (HBC4XX)	4
***	20	Rear Ladder Rack (right) (HBC3XX)	3
***	20	Rear Ladder Rack (right) (HBC2XX)	2
***	21	Evap Cover (HBC4/3/2XX)	1
X1-WORKTOP4U	22	Counter Top w/upstand (HBC4XX)	1
X1-WORKTOP3U	22	Counter Top w/upstand (HBC3XX)	1
X1-WORKTOP2U	22	Counter Top w/upstand (HBC2XX)	1
X1-WORKTOP4	22	Counter Top no upstand (HBC4XX)	1
X1-WORKTOP3	22	Counter Top no upstand (HBC3XX)	1
X1-WORKTOP2	22	Counter Top no upstand (HBC2XX)	1
***	23	Top Fixing Plate (HBC4XX)	4
***	23	Top Fixing Plate (HBC3XX)	4
***	23	Top Fixing Plate (HBC2XX)	3
K8-PROBE01	24	Air Probe (HBC4/3/2XX)	1
***	25	Probe Cover (HBC4/3/2XX)	1
***	26	Evap Fan Cover (HBC4/3/2XX)	1
X1-FAN03	27	Evap Fan (HBC4/3/2XX)	2
X1-EVAP06	28	Evaporator (HBC4/3/2XX)	1
***	29	Evap Drip Tray (HBC4/3/2XX)	1
***	30	Back Cover (HBC4/3/2XX)	1
***	31	Power Cord (HBC4/3/2XX)	1
X1-COMP05	32	Compressor (HBC4XX)	1
X1-COMP06	32	Compressor (HBC3/2XX)	1
***	33	Vaporising Coil (HBC4/3/2XX)	1
K8-PAN01	34	Vaporising Tray (HBC4/3/2XX)	1
X1-FAN01	35	Cond Fan Motor (HBC4/3/2XX)	1
***	36	Cond Fan Blade (HBC4/3/2XX)	1
***	37	Cond Fan Guard (HBC4/3/2XX)	1
***	38	Condenser (HBC4/3/2XX)	1
***	39	Drier (HBC4/3/2XX)	1
X1-CAPILLARY04	40	Capillary (HBC4/3/2XX)	1
***	41	Condenser Filter (HBC4/3/2XX)	1
***	42	Cooling Unit board (HBC4/3/2XX)	1
***	43	Control Panel Upper Hinge (HBC4/3/2XX)	1
***	44	plastic water-proof box (HBC4/3/2XX)	1
***	45	plastic water-proof box cover (HBC4/3/2XX)	1
***	46	Control Panel Bottom Hinge (HBC4/3/2XX)	1
X1-DOOR/COND	47	Panel (HBC4/3/2XX)	1
X1-SWITCH01	48	Power Switch (HBC4/3/2XX)	1

X1-CONTROLLER04	49	Controller (HBC4/3/2XX)	1
X1-LOCK04	50	Door Lock (HBC4/3/2XX)	1
***	51A & 52A	Feet (optional) (HBC4XX)	6
***	51A & 52A	Feet (optional) (HBC3/2XX)	4
***	51	Castors (Unbraked) (HBC4XX)	3
***	52	Castors (Braked) (HBC4XX)	3
***	51	Castors (Unbraked) (HBC3/2XX)	2
***	52	Castors (Braked) (HBC3/2XX)	2

*** Please contact Spares for assistance ***