

## Atosa WTF160L Refrigerated Countertop with Rear Sliding Door Access



The Atosa WTF160L offers a fantastic option to showcase your products in a refrigerated display. With sliding door easy access, it offers a great opportunity to present your goods in an aesthetically pleasing manner.

- ✓ Stainless Steel Interior and Exterior Structure
- ✓ Ventilated Cooling
- ✓ LED Interior Lighting
- ✓ Double Safety Glass at the Front
- ✓ Automatic Defrost
- ✓ Digital Thermostat
- ✓ Adjustable Feet
- ✓ Sliding Glass Rear Door
- ✓ Single Safety Glass at the Rear
- ✓ Stainless Steel Shelves

### SPECIFICATIONS

| Summary                  |         | Power and Performance |              |
|--------------------------|---------|-----------------------|--------------|
| Brand                    | Atosa   | Annual Consumption    | 1683         |
| Model                    | WTF160L | Voltage (V/HZ/PH)     | 220-240/50/1 |
| Shelves (Excluding Base) | 2       | Power (W)             | 242          |

| Key Specifications      |                | Weights and Dimensions        |                      |
|-------------------------|----------------|-------------------------------|----------------------|
| Gross Capacity (Litre)  | 160            | Exterior Dimension (WxDxH) mm | 900 x 560 x 670      |
| Gas Refrigerant         | R290           | Packing Dimension (WxDxH) mm  | 984 x 641 x 790      |
| Climate Class           | 3              | Shelf Dimensions (mm)         | 850 x 288, 850 x 338 |
| Energy Efficiency Class | C              | Insulation Thickness (mm)     | 20                   |
| Refrigerant Type        | Ventilated     | Maximum Load Per Shelf (kg)   | 7                    |
| Temperature (°C)        | +2° to +8°     | Net Weight (kg)               | 75                   |
| Cooling Method          | Air Defrost    | Gross Weight (kg)             | 97                   |
| Thermostat              | Dixell / Carel |                               |                      |
| Compressor              | Embraco        |                               |                      |

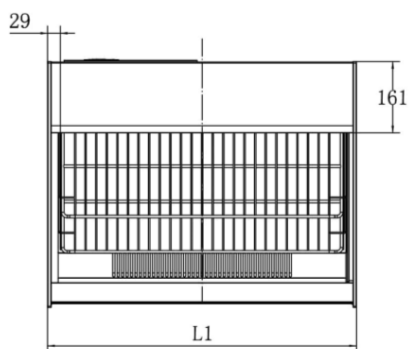
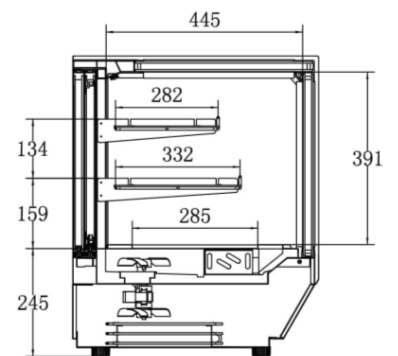
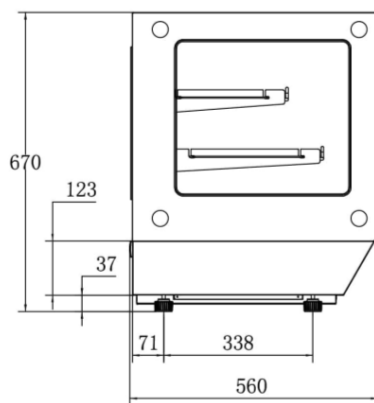
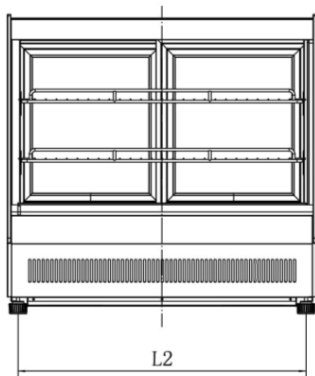

|   |         |         |         |  |
|---|---------|---------|---------|--|
|   |         |         |         |  |
|   |         |         |         |  |
| 2 | WTF160L | 900     | 850     |  |
| 1 | WTF120L | 700     | 650     |  |
|   |         | L1 (mm) | L2 (mm) |  |

**ATOSN**<sup>®</sup>  
LEADING MANUFACTURING COMPANY