



CN6 - Silverlink 600 Free-standing Ambient Open-Top Pedestal without Doors - W 600 mm

Designed to suite with other products in the Silverlink 600 range, the Pedestal's adjustable shelf provides flexibility for storing bulky items.

- ✔ Designed to suite with the Silverlink 600 range
- ✔ Silverlink 600 counter-top units are securely attached to pedestals by means of fixing screws supplied
- ✔ Adjustable shelf provides flexibility for storing bulky items
- ✔ Adjustable feet for alignment even on uneven floors

Specifications

Summary

Range Name	Silverlink 600
Unit Type	Free-standing
Available in UK Only	No
UK Warranty	2 Years Parts and Labour Warranty
Export Warranty	Contact your local dealer
GTIN Code	5056105100867

Weights and Dimensions

Unit Height (External) mm	660
Unit Width (External) mm	600
Unit Depth (External) mm	600
Height (Internal) mm	456
Width (Internal) mm	598
Depth (Internal) mm	567
Shelf Dimensions Width mm	550
Shelf Dimensions Depth mm	530
Net Weight Kg	17.1

Shipping

Packed Weight Kg	23.7
Packed Height cm	88.3
Packed Width cm	70.3
Packed Depth cm	70.3

Available Accessories

PSH6	600 PEDESTAL SHELF
-------------	--------------------

Technical Picture

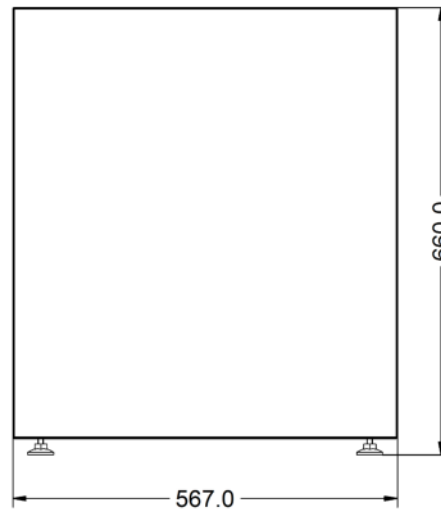
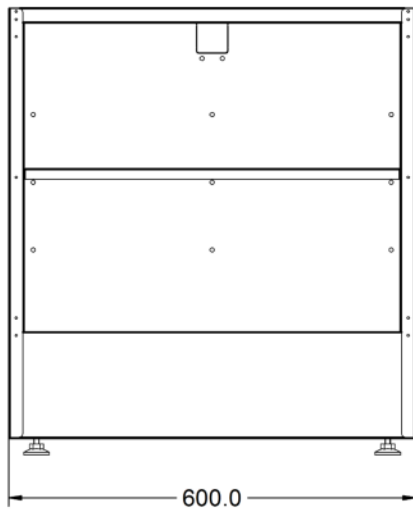
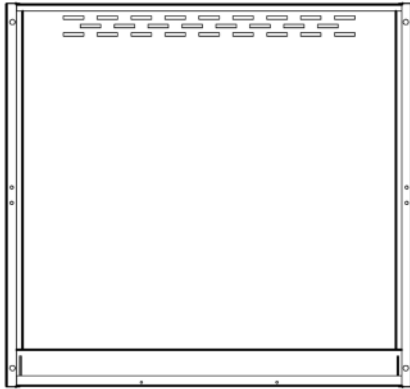

Lincat Limited

Whisby Road,
Lincoln, LN6 3QZ,
United Kingdom

Company No: 2175448

A member company of



Customer Care

Tel: +44 1522 875500
Email: care@lincat.co.uk

Export Customers

Tel: +44 1522 503250
Email: export@lincat.co.uk

Opening Hours

Monday – Friday:
8.30am – 5pm