

## Specification/Data sheet

### Stand XS model XS 6 2/3



Article number: 60.31.029

#### Description

The stand XS ensures safe installation of the iCombi Pro XS, CombiMaster Plus XS 6-2/3 and SelfCookingCenter XS. The cooking system can be fixed on the base frame using a mounting kit.

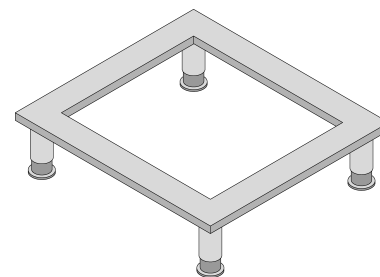

#### Features

- open on all sides
- Height-adjustable feet (up to 4.5 cm)
- Mounting kit for fixing the cooking system on the base frame
- Levelling by levelling out unevenness or sloping work surface with a max. 2° incline
- Elevation of the unit drain so that it can go over an overflow edge on the working surface of up to 16 cm
- Can be fixed onto the working surface (welded or screwed onto the working surface with threaded bolts)
- The rubber slide protection included prevents the unit from slipping during operation

#### Technical Specifications

- LxWxH: 629 x 438 x 148 mm
- Max. fixed power: 270 kg
- Weight: 4.5 kg

#### Material

- Rust-free stainless steel (CNS 1.4301)

