

## Datasheets

### Condensation breaker - Type 6-1/1, 10-1/1, 6-2/1, 10-2/1



#### Article number

60.72.592

#### Description

Accelerates the expulsion of steam and other vapours from the vent pipe. Steam and vapours can thus be diverted through a pipe into an extraction system.

#### Intended use

This product is only intended for commercial use, such as in restaurant kitchens or catering operations for schools, hospitals, or delis. Any other use runs counter to its intended purpose, and could be dangerous. Any other use runs counter to its intended purpose, and could be dangerous.

#### Technical specifications

Connection diameter:	66 mm
----------------------	-------

#### Dimensions and weights

Width (W):	100 mm
Height (H):	458 mm
Depth (D):	75 mm
Weight:	1,27 kg

#### Material

Rust-free stainless steel (CNS 1.4301/AISI 304)

#### Note

- For iCombi Pro and iCombi Classic models 6-1/1, 6-2/1, 10-1/1 and 10-2/1
- For SelfCookingCenter whiteefficiency and CombiMaster Plus model 102
- For SelfCookingCenter (before 09/2011), CombiMaster and CPC models 102, 201 and 202



Datasheets

Condensation breaker - Type 6-1/1, 10-1/1, 6-2/1, 10-2/1

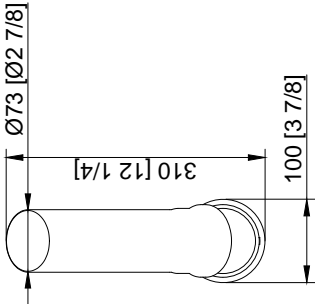
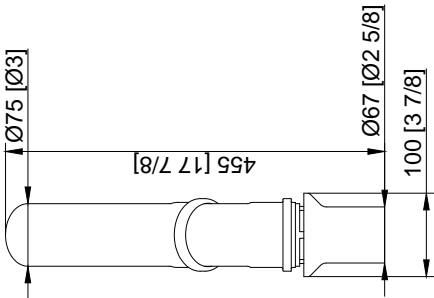
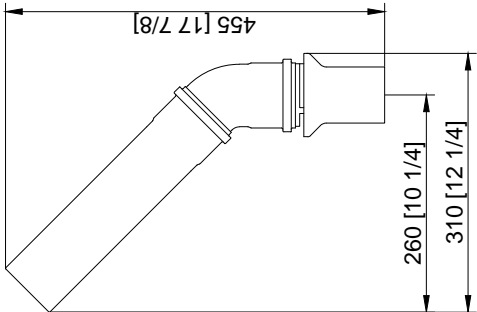

Information/Information/Information		Anschlussplan/Connection diagram/Plan de connexion	
Zachungsausschnitt unterliegt nicht den Änderungen! Printed drawing is not automatically updated! Le mise à jour n'est pas assurée sur les plans papier!		Condensation breaker CP-ACC 6-11 and 6-21 and 10-11 and 10-21 (master view)	
RATIONAL AG 2019		Date/Date/Date	
Revisions/Revisions/Revisions		Ersteller/Creator/Créateur	
Index		Maßstab/Scale/Echelle	
1		Abmessungen/Dimensions/Dimensions (mm/inch)	
2		Nr./No./Beschreibung/Description	
3		1	
4		2	
5		3	
6		4	
7			
8			