

Heavy Duty 2/1 Refrigeration

Glass Door Refrigerators and Freezers

CBP172CR

Anti-fog film on freezer door to prevent condensation and save energy

CEP2144CR

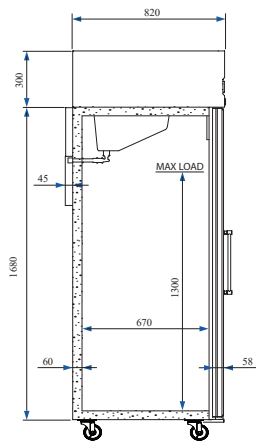

Refrigerators suitable for fresh meat storage

FEATURES

- High grade AISI 304 stainless steel exterior & interior
- 4 x GN2/1 shelves per door, shelf size 650 x 530mm
- Shelf with denser wires especially designed for storing bottles in an upright position
- Internal LED lighting
- Triple glazed door(s)
- Lock as standard
- Heavy duty castors as standard
- Replaceable door gasket
- Anti-fog film on freezer model doors to prevent condensation
- Refrigerator models - Epoxy coated evaporator to resist corrosion

TECHNICAL SPECIFICATIONS

- Controller: Digital controller with temperature display
- Cooling: Ventilated
- Defrost: Automatic
- Refrigerant: R290
- Climate Class: 4
- Power Supply: 13amp

MODEL	DOOR	TEMPERATURE RANGE	GROSS CAPACITY	EXT. DIMENSIONS (H x W x D mm)	POWER CONSUMPTION	WEIGHT (kg)	RRP
CAP172CR	1	-2°C ~ +8°C	654L	2115 x 720 x 905	636W	160	£2,112.00
CBP172CR	1	-10°C ~ -18°C	654L	2115 x 720 x 905	627W	162	£2,598.00
CEP2144CR	2	-2°C ~ +8°C	1432L	2115 x 1440 x 905	878W	256	£3,332.00
CFP2144CR	2	-10°C ~ -18°C	1432L	2115 x 1440 x 905	1032W	280	£3,898.00



MODEL	DECIBELS
CAP172CR	59dBA
CBP172CR	60 (66*) dBA
CEP2144CR	59dBA
CFP2144CR	62 (67*) dBA

* during defrost

