



## Connecta HEG365 & HEG364 2 Tier Service Trolleys

HEG365- 2 Tiers Trolley Small size

710x410xH810mm

HEG364 - 2 Tiers Trolley Large size

860x530xH950mm

### Assembly Instructions

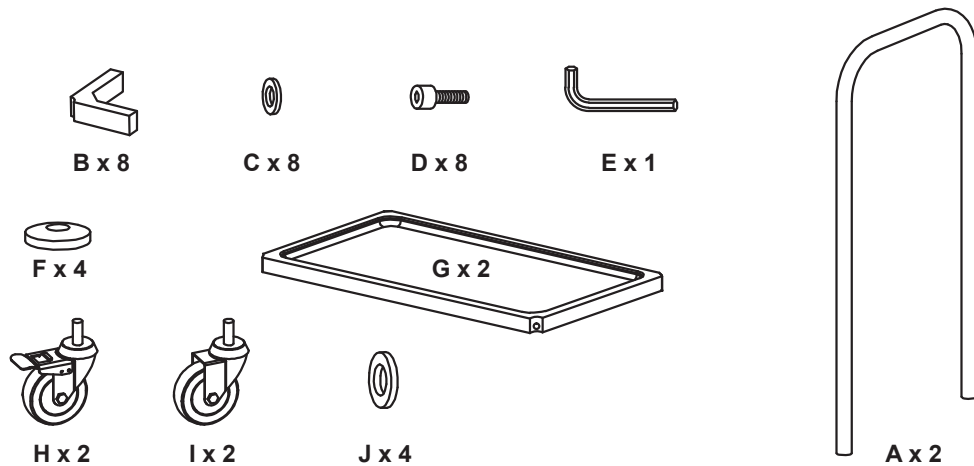

1

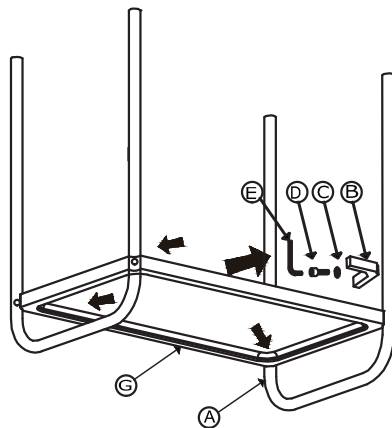

2

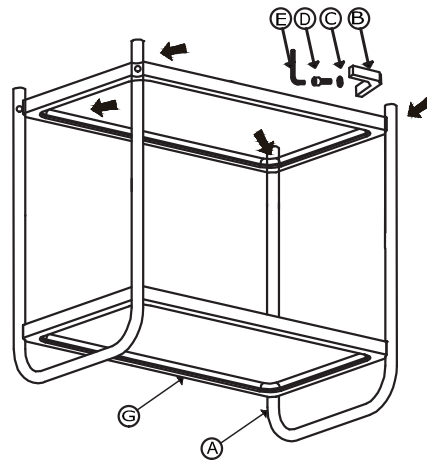

3

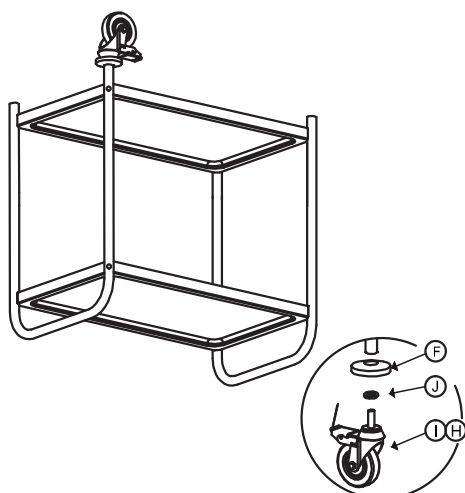

4



## Parts (check before assembly)

<u>PARTS NAME</u>	<u>QUANTITIY</u>
● Tubular Handles (A)	2 pieces
● Corner Fittings (B)	8 pieces
● Wahers (C)	8 pieces
● Screws (D)	8 pieces
● Hex Key (E)	1 piece
● Castor Protectors (F)	4 pieces
● Shelves (G)	2 pieces
● Castors with brake (H)	2 pieces
● Castors without brake (I)	2 pieces
● Washers (J)	4 pieces

## Assembly

1. Turn the shelves & tubular handles upside down to start assembly. The shelf with "CONNECTA" logo to be assembled first.
2. Assemble the corner fittings, washers and use **Hex** key gently tighten screws.
3. Repeat step "2" for middle shelf (3-tier) and lower shelf.
4. Tighten all screws firmly.
5. Fit the Castor protectors and washers.
6. Screw on the castors.
7. Remove the protective coating from the shelves.

## Safety Tips

- DO NOT stand or climb on the trolley.
- DO NOT drop heavy items on the trolley.
- DO NOT place heavier items on the top of the trolley than on the bottom.

## Cleaning

- Clean the trolley using warm soapy water.
- Dry thoroughly after cleaning