

# Electric Fryer

**BF6**

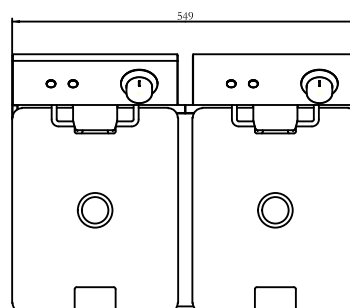

**BF6+6**

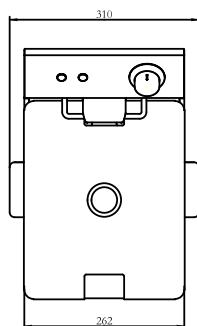
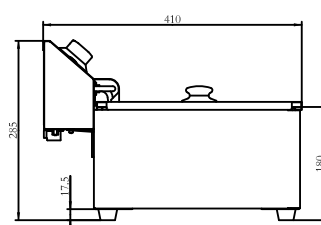
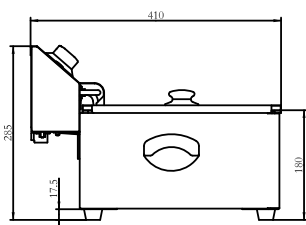

## FEATURES

- Stainless steel construction
- Removable tank
- Mesh batter plate
- Lids and baskets supplied
- Basket dimensions - 240 x 185 x 100mm deep
- Safety cut out

## TECHNICAL SPECIFICATIONS

	<b>BF6</b>	<b>BF6+6</b>
Controller:	Manual thermostat	
Temperature Range:	+50°C ~ +190°C	
Power Consumption:	2500W	2500+2500W
Power Supply:	13amp	2x 13amp

MODEL	FINISH	CAPACITY	EXTERNAL DIMENSIONS (H x W x D mm)	WEIGHT (kg)	RRP
BF6	Stainless steel single tank	6L	285 x 310 x 410	6	
BF6+6	Stainless steel twin tank	2x 6L	285 x 549 x 410	12	

