

## USER GUIDE



## PREPARATION

- CHECK THE **DRAIN PLUG** IS PUSHED FIRMLY IN PLACE AND **FILTERS** ARE PROPERLY LOCATED.
- CHECK THE **DETERGENT** CHEMICAL (RED) AND **RINSE AID** CHEMICAL (CLEAR) SUPPLY TUBES - WITH **FOOT VALVES** ATTACHED ARE SUBMERGED IN SUFFICIENT CHEMICAL. WHEN THE CHEMICAL IN THE CONTAINER IS LOW REPLACE WITH A FULL CONTAINER. DO NOT USE THE MACHINE IF THERE IS NO CHEMICAL.
- CHECK THE DOOR IS CLOSED AND PRESS THE **POWER SWITCH** - THE GREEN **POWER LAMP** WILL COME ON.
- WAIT FOR THE MACHINE TO FILL WITH WATER AND REACH THE CORRECT WASHING TEMPERATURE. THE **MACHINE READY LAMP** WILL COME ON.

## OPERATION

- REMOVE ALL DEBRIS FROM THE ITEMS TO BE WASHED BEFORE PLACING THEM INTO THE BASKET.
- LOAD ITEMS INTO THE BASKET PROVIDED ENSURING NO ITEMS ARE COVERING EACH OTHER - PUSH THE BASKET INTO THE MACHINE.
- CLOSE THE DOOR - PRESS THE **CYCLE START SWITCH** - THE WASHING CYCLE WILL BEGIN AND THE **WASH CYCLE LAMP** WILL COME ON.
- AT THE END OF THE CYCLE THE **WASH CYCLE LAMP** WILL GO OUT - OPEN THE DOOR AND PULL OUT THE BASKET.
- ALLOW EXCESS WATER TO RUN OFF BEFORE REMOVING THE BASKET.
- CLOSE THE DOOR IF YOU ARE NOT WASHING TO CONSERVE TEMPERATURES .

## WATER SOFTENER REGENERATION MODELS

- THE **SALT LOW LAMP** WHEN ON WARNS IF THE SALT CONTAINER IS LOW ON SALT OR EMPTY.
- UNSCREW THE **SALT CONTAINER LID** LOCATED INSIDE THE WASH TANK AND FILL WITH GRANULAR CATERING SALT ( THE SALT CONTAINER WILL REGENERATE APPROXIMATELY FIVE REGENERATION CYCLES & HOLDS 500g OF SALT).DO NOT OVERSPILL, IF SALT IS SPILT ONTO STAINLESS STEEL RINSE THOROUGHLY WITH WATER. ENSURE THE **SALT CONTAINER LID** IS SECURE AFTER FILLING.
- THE WATER SOFTENER REGENERATION CYCLE WILL BE FULLY AUTOMATIC AND WHEN REQUIRED STARTS AFTER THE FIRST FILL AND DURING THE INITIAL HEATING OF THE MACHINE.
- THE REGENERATION LAMP WILL BE ON WHILE THE MACHINE CLEANS AND REGENERATES THE SOFTENER SYSTEM.
- THE MACHINE WASH CYCLE START IS DISABLED DURING THE 15 MINUTE REGENERATION. DO NOT SWITCH OFF THE MACHINE WHILE REGENERATING.
- WHEN REGENERATION IS COMPLETE THE **WATER SOFTENER REGENERATION LAMP** WILL GO OUT AND THE MACHINE WILL CONTINUE TO HEAT.
- WAIT FOR THE MACHINE TO REACH THE CORRECT WASHING TEMPERATURE. THE **MACHINE READY LAMP** WILL COME ON.
- THE MACHINE IS NOW READY TO START WASHING.

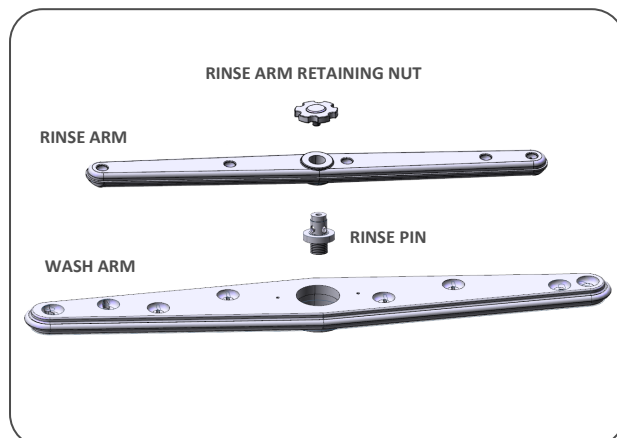
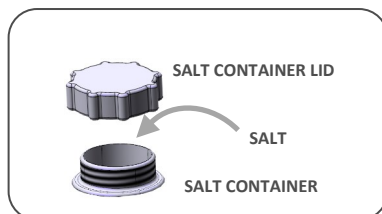
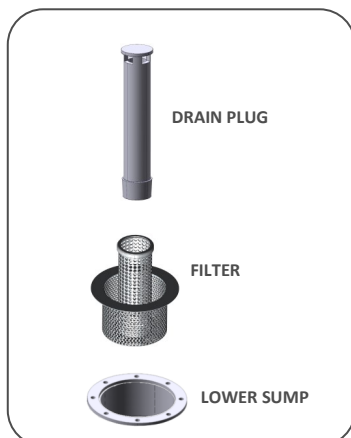

## DAILY CLEANING & MAINTENANCE

**WARNING:** Do not use any chemical compounds in or around the machine containing chlorine-ions (bleach, chlorine, salt, etc) either undiluted or in a diluted solutions such as de-stain, de-tan, brine, Milton fluid etc. They are incredibly corrosive to stainless steel A304 and can quickly cause the appearance of 'pin hols' in the stainless steel and rust to occur.

If chemicals containing chlorine-ions are put into the machine, ensure that all debris is removed and the machine thoroughly rinsed to ensure no corrosive chemicals remain.

Please note: this type of corrosion is due to misuse and should it occur will not be covered under warranty.

Do not use steel wool scouring pads to clean the inside or outside of the machine.

Correct PPE should be worn at all times when operating, cleaning or maintaining the machine.



At the end of the session turn off the **POWER SWITCH**. Do not remove the **FILTER** at this stage.

Remove the **DRAIN PLUG** - The wash tank will empty -

(Machines fitted with drain pump will automatically start to pump the water out).

Collect the debris and remove from the wash tank.

Clean around the wash tank - door surrounds - and hinges with an 'Addis' type washing up brush and cleaning cloth.



Remove the **FILTER** - and clean thoroughly with an 'Addis' type washing up brush.

Run water over the **FILTER** while working the brush in to all parts of the filter.

Fibers and food debris can be cleaned easily from the surfaces and **FILTER** holes by brushing.

Do not hit the **FILTER** against the side of a sink or food bin. This will damage or distort the filter and fibers and food debris will not be completely removed.

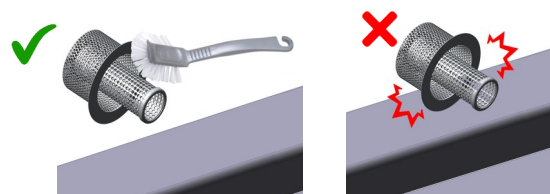

Be careful not to allow debris to go down into the **LOWER SUMP** as this may damage the internal pumps and wash system inside the machine.

Remember to replace the **FILTER** after cleaning. Replace the drain plug before use.

Don't use the machine without the filters in position.

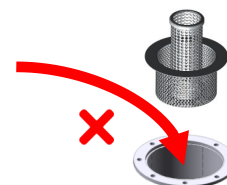

Regularly check the **RINSE JETS** and **WASH JETS** are clear of debris or limescale - remove if necessary by unscrewing the **RINSE ARM RETAINING NUT** that holds the **RINSE ARM** in place.

Remove the **RINSE PIN** that holds the wash arm in place - Clean both arms thoroughly and reassemble.

**Cutlery, plastic wrappings and broken glass should be removed from inside the wash tank as part of the daily cleaning routine.**



Before washing scrape the bulk of the food from the items to be washed into a food bin and remove any paper, plastic or objects.

If possible pre rinse the complete basket full of items with water before loading the basket into the machine.

If pre washing with soaps or washing liquids you must rinse the item thoroughly before placing them into the basket.

The introduction of washing up liquids into the machine can cause excessive foaming inside the wash tank, this reduces washing performance and prevents water draining. Excessive foaming in the wash tank may damage the machine.



The use of washing up liquids and soaps will reduce performance and may damage the machine



### Detergent chemical

The red tube to the machine is used for the detergent.

The amount of detergent dosed depends on the quality and dilution information provided on the detergent chemical container. You may need to adjust the dosing quantity if you change the supplier of the chemical product. Please see the dosing guide for more information.

**Incorrect dosing quantities will always give poor washing results.**



### Rinse aid chemical

The clear or blue tube to the machine is used for the rinse aid chemical

The amount of rinse aid dosed depends on the quality and dilution information provided on the rinse aid chemical container. You may need to adjust the machines internal dosing pumps if you change the supplier of the chemical product. Please see the dosing guide for more information.

**Incorrect dosing quantities will always give poor washing results.**



Follow the chemical manufactures advice and warnings for liquid detergent and rinse aid  
Follow PPE guidelines from the chemical manufacturer

**SERVICE CALLS TO RECTIFY FAULTS CAUSED BY 'THE LACK OF ROUTINE MAINTENANCE' WILL BE CHARGED FOR AND YOUR WARRANTY MAY BE AFFECTED**