

Marketing Department
Burco Appliances Ltd
Talbot Road
Mexborough
South Yorkshire
S64 8AJ

Keep warm function (4 litre only)

- 1 Fill the kettle and switch on as normal.
 - 2 Push the keep warm button **6** to the on position, the indicator will light.
 - 3 The kettle will boil as normal. The keep warm feature will then keep the water in the kettle at near to boiling point.
 - 4 To reboil activate the on/off switch. The kettle will reboil in a few seconds.
- Please note: The keep warm function can be activated at any time in the boil cycle.

Cleaning

Before cleaning and maintenance, switch the appliance off, unplug it and allow to cool.

- Wipe the outside with damp cloth.

IMPORTANT: Do not use abrasive cleaners on the outside of the kettle which may scratch the surface.

Descaling

In hard water areas scale will form on the element and walls. This will adversely affect the operation of the kettle if allowed to accumulate. Descaling can be simply achieved by using a proprietary descaler. Choose one recommended for stainless steel kettles. It is important to follow the instructions given on the descaling solution carton.

IMPORTANT: Failure to de-scale will invalidate your guarantee.

Guarantee

This electric catering kettle is guaranteed for a period of 12 months from the date of purchase against defective materials or faulty workmanship.

This guarantee is given subject to the kettle being used in accordance with the instructions on the supply voltage marked on it and to the usual fair wear and tear conditions.

The guarantee does not cover consequential damage arising out of any failure acceptable under guarantee, nor does it cover damage resulting from misuse, accident or unauthorised alterations to the kettle.

Proof of purchase will be required. In any communication with the manufacturer, it is essential to quote the model and serial number marked on the base of the kettle.

This guarantee, in no way diminishes the buyer's statutory rights.

Please fill in and return the tear off section to register the guarantee with Burco.

BURCO

Commercial kettle



Please read and keep these instructions

Model 77008
Weight 1.62kg
Dimensions
H280mm, W305mm, D230mm
4 litre capacity

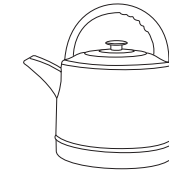

Model 77007
Weight 0.87kg
Dimensions
H225mm, W270mm, D200mm
2 litre capacity

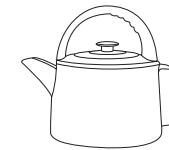

Getting the best from your kettle...

- Empty the water out of the kettle after first boiling to clean away any deposits that are left in the kettle after the manufacturing process.
- It is important to descale as the performance of the kettle and auto switch-off will be impaired.
- Always pour water slowly and carefully to prevent the splashing of scalding water.



Burco Appliances products are intended for commercial use as detailed in these instructions.

Burco Appliances has a policy of continuous improvement in product quality and design. The Company, therefore, reserves the right to change the specification of its models at any time.

Affix
postage stamp
here

Burco Appliances Limited

A MEMBER OF THE GLEN DIMPLEX GROUP
Talbot Road, Mexborough,
South Yorkshire, S64 8AJ
Tel 01282 427241 Fax 01282 831206
Email sales@burcodean.co.uk

BURCO

CP77007 M UK 11/04

www.burco.co.uk



Important safety instructions

The use of any electrical appliance requires following common sense safety rules.

Primarily there is danger of personal injury and secondly danger of damage to the appliance and property. These are indicated in the instructions text by the following two conventions:

WARNING: Danger of personal injury

IMPORTANT: Damage to the appliance

In addition we offer the following essential safety advice.

Location

- Always locate your kettle away from the edge of a worktop.
- Ensure that the kettle is used on a firm flat surface.
- Do not use the kettle outdoors or in a bathroom.
- WARNING: Do not place the kettle onto a metal tray or metal surface whilst in use.**

Personal safety

- To protect against fire, electric shock and personal injury do not immerse the mains lead, plug or kettle in water or any other liquid.
- Always pour hot water slowly and carefully without tipping the kettle too fast to prevent splashing and spillage.
- Extreme caution must be used when moving a kettle containing hot water.
- Do not touch hot surfaces, use handles or knobs.
- Always close the lid securely, otherwise the kettle may not switch off automatically and may spit out boiling water.
- Avoid contact with steam from the spout when the water is boiling or just after it has switched off.
- Take care if opening the lid for refilling when the kettle is hot.
- Do not fill above the MAX mark, otherwise boiling water may be ejected.
- Do not hold the switch in the on position or tamper with the switch to fix it in the on position as this may cause damage to the switch-off mechanism.

- Unplug from the outlet before cleaning.
- Allow to cool before putting on or taking off parts and before cleaning.

Mains lead

- The mains lead should reach from the socket to the kettle without straining the connections.
- Do not let the mains lead hang over the edge of the table or the counter where a child could reach it and keep it away from any hot surfaces.
- Do not let the lead run across an open space e.g. between a low socket and table.
- Do not let the lead run across a cooker or toaster or other hot area which might damage the lead.
- Do not place the kettle where the mains lead could fall into a sink.

Children

- Children do not understand the dangers associated with operating electrical appliances. Never allow children to use this appliance.

Other safety considerations

- Do not operate with a damaged lead or plug, or after an appliance has malfunctioned, or has been dropped or damaged in any way. Contact Burco Appliances for advice on examination, repair, or electrical or mechanical adjustment.
- The use of attachments or tools not recommended or sold by Burco may cause fire, electric shock or injury.
- Do not place on or near a hot gas or electric burner, or in a heated oven.
- Do not tamper with the connector in anyway.
- Do not use the kettle for any use other than to boil water.
- Disconnect the kettle from the mains supply when filling or pouring.

- Unplug from the mains outlet when not in use and before cleaning.

Treating scalds

- Run cold water over the affected immediately. Do not stop to remove clothing get medical help quickly.

Electrical requirements

Check that the voltage on the rating plate of your appliance corresponds with your electricity supply which must be A.C. (Alternating Current).

If the socket outlets are not suitable for the plug supplied with this appliance, the plug should be removed and the appropriate one fitted.

WARNING: The plug removed from the mains lead, if severed, must be destroyed as a plug with bared flexible cord is hazardous if engaged into a live socket outlet.

WARNING: This appliance must be earthed.

Should the fuse in the 13A plug require changing, a 13A BS 1362 fuse must be fitted.

Features

- Lid handle
- Spout
- 2 litre exposed element
4 litre concealed element
- Mains connector
- On off switch/indicator light
- Keep warm switch/indicator light
- Secondary support handle

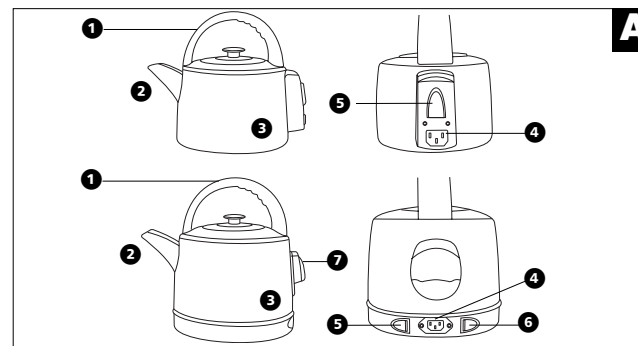

Before first use

- Remove all packaging.
- Empty the water out of the kettle after first boiling to clean away any deposits that are left in the kettle after the manufacturing process.
- Rinse thoroughly and wipe dry.

Using

- Fill the kettle with at least enough water to cover the element. When filling the 4 litre kettle a minimum of a litre should be used. Do not fill above the MAX mark indicated inside the kettle.
 - Boil only as much water as you need as this saves electricity.
- Push the mains lead connector firmly into the kettle.
- Plug in and switch on at the wall socket.
- Switch the kettle on using the on/off switch the indicator light will illuminate.
- When the water boils the kettle will switch off automatically.
 - To reset shortly after boiling you will need to push the on/off switch in and continue to push until it starts to boil.
- Carefully disconnect the mains lead connector ensuring you hold the kettle level.
 - To re-boil, switch to 'ON' again. If the kettle has just switched off wait a minute or so before switching it back on again.
 - If you do not put in enough water, or switch on the kettle when it is empty, the safety cut-out will switch off the power automatically. If this happens, refill and wait a few minutes for the element to cool, then use as normal.

Guarantee registration

Appliance model

Serial no.

Date of purchase

Customer name

Address

Please help us to further improve our products by ticking the one main reason for purchase

Price

Styling/Appearance

Features

Previous Burco ownership

Dealer recommendation

Service back-up

Other (please state)

Where did you buy your Burco appliance ?

Dealer/Retailer

Would you like more information on Burco products?

Yes

No

CUT HERE & DETACH