



INSTRUCTION REF: IN150
ISSUE No. 2
DATE 27.06.07
Page 1 of 11

TELEPHONE: SERVICE (44) 01332 875665
FAX: SERVICE (44) 01332 875536

PARRY CATERING EQUIPMENT

TOWN END ROAD, DRAYCOTT, DERBY, DE72 3PT
SERVICE TEL: 01332 875665 FAX: 01332 875536

- INSTALLATION INSTRUCTIONS
- SAFETY INSTRUCTIONS
- USER INSTRUCTIONS

REFRIGERATED DISPLAY UNIT
GPC10/GPC15/GPC10SS/GPC15SS

1. General

Read these instructions carefully, they explain how to correctly and safely position, install, use and service the cabinet.

Keep these instructions in a safe place and available for other users.

The cabinet must be installed and started up in compliance with the manufacturer's instruction and in conformance with local instruction and regulations. If a defect occurs in the cabinet or cabinet equipment, or the cabinet does not operate normally, check that this does not create a hazard to people or property. If necessary, disconnect the cabinet and contact the nearest service office.

All users of the cabinet must be aware of how to use the cabinet correctly and safely.

2. Prohibited use

Using the cabinet in any way other than specified in these instruction is prohibited. Only products that are specified in these instructions or in the brochure for the cabinet may be stored in the cabinet. The manufacturer accepts no liability for incidents that are caused by using the cabinet in contravention of these instructions, or with disregard for the warnings in these instructions or without following them.

3. Intended use

This refrigerated case is designed to maintain the correct storage temperature required for bakery and confectionery products.

4. Type and versions

This refrigerated case is available in two lengths i.e. 100 and 150, the temperature inside the case is +4 and +8°C. The case is produced in the following versions:

- Standard version is designed for ambient conditions: +25°C/60%r.h., available in colours: Gold, Grey, White, Black.
- Inox version is designed for ambient conditions: +25°C/60%r.h., it is from stainless steel.
- Tropy version is designed for ambient conditions: +30°C/75%r.h, available in colours: Gold, Grey, White, Black.
- Neutral version is without aggregate, available in colours: Gold, Grey, White, Black.

The case is equipped with 3 shelves, each shelf is provided with lighting. The case is equipped with a light switch. The lights heat the cabinets when switched on. Normally this does not have any adverse effect but we recommend that the lighting is turned off when it is not needed. The cabinets fixtures can be positioned alongside each other to form sales rows, this series also includes other none cooled units:

- Corner unit (the same number of shelves and height)
- Cash desk

5. Packing and transport

Transport or move the cabinet to its final site in the original company package. Place the ski of the forklift under the red arrow. Do not touch the case's ramp during transport and positioning.

6. Operating Elements

The panel with operating elements is placed on the right side of the case from the service side. There is a electronic control unit and three buttons on the panel – see picture 1 below:

1. Electronic control unit – do not operate, only for service

2. Description of operated buttons:

- a) White button - lighting switch
- b) Green pilot light - network controller
- c) Orange button - ON-OFF switch

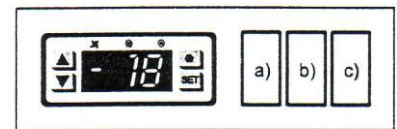

7. Work statement with operating elements

When connecting the case to electricity – the green pilot light switches on. To start up the unit press the orange ON-OFF button, the unit will start cooling according to pre-set temperature in electronic control unit. To switch on the light in the case press the White Button.

OPERATING ELEMENTS

To increase the temperature

manual defrosting

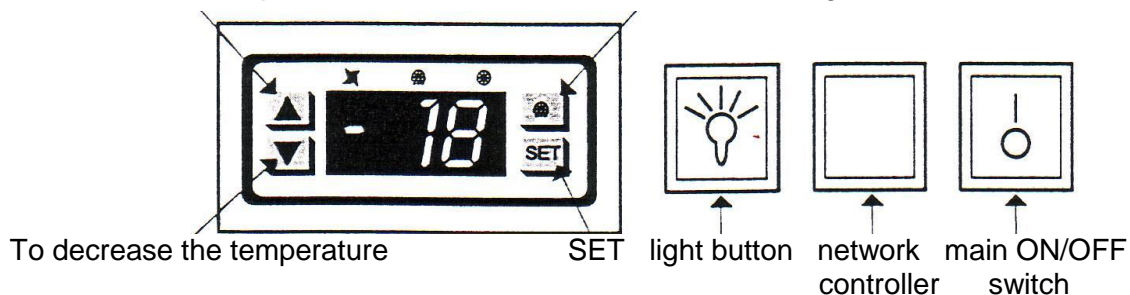

Adjustment of cooling temperature:

If the pre-set temperature doesn't suit your requirement use the electronic control unit to modify.

Please follow procedure below:

- Press the SET button and using up/down arrows set the required temperature
- To confirm the adjustment press set again

Evaporator defrosting

The evaporator defrosting is made automatic at timed intervals.

Manual evaporator defrosting:

When required it is possible to defrost the evaporator outside of the set intervals, for manual defrost of the evaporator press the manual defrost button for at least 5 seconds.

Except when changing the required temperature or manual defrost it is strictly prohibited to operate the electronic control units. The manipulation of electronic control units should only be carried out by qualified service personnel.

8. Electrical connection

The case operates on single-phase 230v/50Hz voltage. The supply socket **must** be earthed and protected by a 10A or 16A slow fuse. No other appliance should be connected to the same fuse.

9. Siting conditions

Adjust the case to stand perpendicular using the adjustable feet.

Check when siting the cabinet that:

- It is not placed in the immediate vicinity of a heat source i.e. heater or spotlight.
- It is not placed in direct sunlight.
- It is not placed in the proximity of air conditioning equipment or the main entrance to the premises.
- It is not positioned so as to block inlet air or prevent ventilation for the machine part of the case. Do not place goods or objects in front of or behind the case.

Correct positioning of the cabinet optimises temperate conditions, performance and electricity consumption whilst also maximizing the service life of the compressors.

10. Cleaning before first use

Clean the surfaces and storage compartment for foodstuff with a mild liquid detergent before using the case. Follow the instruction provided with the detergent. Dry the surfaces of the case carefully using a towel.

11. Start-up and principle of operation

Connect the plug to the supply socket. The case is pre-set in the factory to operate in normal ambient conditions (i.e. relative humidity 60%, and ambient temperature +25°C) so that the normal temperature in the cabinet is +4..+8°C.

Switch-on the case pushing the main switch ON-OFF.

Leave the case empty and let it run for at least one hour, or until the set temperature is reached. When the unit starts the evaporator will start cooling and the fans circulate the cooled air through the grid behind the bottom shelf up to the top of the case, the cooled air is evenly distributed over all shelves in the case towards the front glass cover. Replacement air is sucked through the front grid at the bottom of the cabinet to the evaporator and cooled for the next circuit.

The front grid must always be kept unobstructed, so avoid placing goods or subjects in front of it. The space between the shelves and slide doors at the rear should also be kept clear (i.e., no goods should protrude over the rear edge) to avoid disrupting the airflow. The unit is equipped with an automatic defrosting device. Drain water from defrosting goes to the equipped tank. Drain water is automatically defrosted due to hot air from aggregas and copper snake.

Loading the case

When loading the case – follow these instructions:

- An unobstructed space of at least 20mm must be left between the products and the shelves.
- Products must not be placed in front of the inlet and outlet grids
- Products must not protrude over the edges of the shelves

Improper loading of cabinets will disrupt the airflow and raise the temperature of the products in the cabinets.

Case is not designed to cool down products but to maintain them at the temperature at which they are placed in the case. Food products which are

warmer than the specified temperature should not be placed into the cabinet. Do not leave any goods inside the case after demise of sale.

12. Maintenance

The following maintenance procedure should take place at least twice a year, unless otherwise recommended:

- Disconnect the case from the power supply
- Empty the cabinets
- Allow the temperature to reach the ambient one
- Remove the air inlet and outlet grid at the bottom of the shelf, check there is no dirt or obstacles under the vent, vacuum clean if necessary.
- Check that the condenser is clean at least every other month, and if necessary clean it: vacuum clean the condenser fins and check the space between fins are unobstructed, do not use any steel brush or other sharp tools which could damage the fins.
- Check the cord – it has to be in perfect condition, if there is any damage the cord needs to be changed by a service engineer in accordance with safety regulations.

13. Troubleshooting

Before calling the service office, check that:

- a) the plug has not come out of the supply socket and the main supply is working
- b) the fuse for the cabinet is intact
- c) the cabinet is correctly positioned
- d) the condenser is not blocked or dirty
- e) the products are placed in the cabinets correctly
- f) the airflow in the cabinets is not disrupted

If the reason for the malfunction can not be identified, disconnect the electrical supply to the cabinet and contact the service engineer.

Check the operating sound of the cabinets and the cleanliness of the condenser and evaporator regularly. Also check regularly that the air inlet and outlet are not obstructed by debris, packaging waste, etc. that could obstruct the air circulation.

14. Interruption of mains supply

After a power cut or interruption in the electricity supply the case will start automatically. The evaporator tank could be filling during the interruption.

15. Servicing and spare parts

The specification of the case are marked on the rating plate. Only authorised fitters of cold storage and electrical equipment may carry out servicing and repair of the machinery and electrical equipment of the cabinet. We recommend that only original spare parts from our company are used when necessary.

16. Disposal at end of service life

When the useful end of service life of the cabinet expires, the cabinet must be disposed of in compliance with local regulations and instructions. Seek expert advice when disposing of substances that are harmful to the environment and when utilizing recycling materials.

17. Accessories

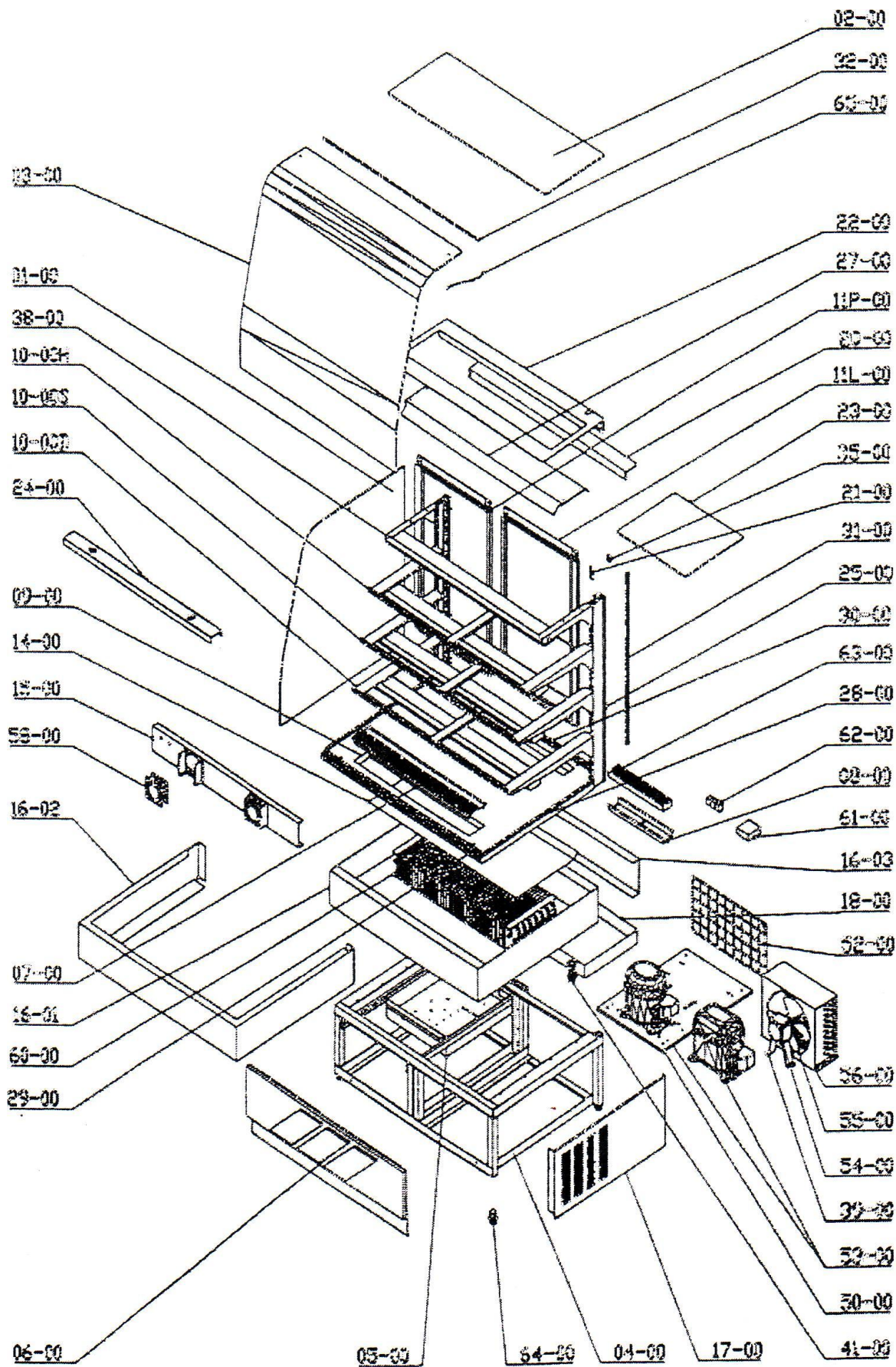

COOLING SHOWCASE

List of Spare Parts

01-00	Side glass
02-00	Top glass
03-00	Front glass
04-00	Base (welded)
05-00	Drawer (welded)
06-00	Decorative covering (set)
07-00	Front ventilation louver (welded)
08-00	Honeycomb holder
09-00	Display plate (set)
10-00H	Top shelf (mounting set)
10-00S	Middle shelf (mounting set)
10-00D	Low shelf (mounting set)
11L-00	Sliding doors – left (mounting set)
11P-00	Sliding doors – right (mounting set)
14-00	Evaporator cover
15-00	Fan panel sheet (set)
16-01	Insulated base (set)
16-02	Front base plate
16-03	Back base plate
17-00	Side plate
18-00	Draining tray
20-00	Top slide rail for doors (set)
21-00	Distance bracket
22-00	Top frame
23-00	Glass shelf plate
24-00	Support plate for lighting
25-00	AL – profile
27-00	Moulder for air circulation (plexi)
28-00	Side glass strip
29-00	Front glass strip
30-00	Low slide rail for doors
31-00	Sliding doors sealing profile (gasket)
32-00	Front glass fuse profile
35-00	Shelf holder
38-00	Top frame console
39-00	Fan holder/ON-39/
41-00	Draining threaded joint
50-00	Compressor chassis
52-00	Covering fan grid/il-52/
53-00	Compressor GP14 TB or GB18 TB (trophy version)
54-00	Condenser fan motor
55-00	Condenser fan blade
56-00	Condenser
58-00	Evaporator fan (90mm)
60-00	Evaporator
61-00	Electronic control unit

62-00	Evaporator
63-00	PVC honeycomb
64-00	Rectifier stop-gap ending

1500

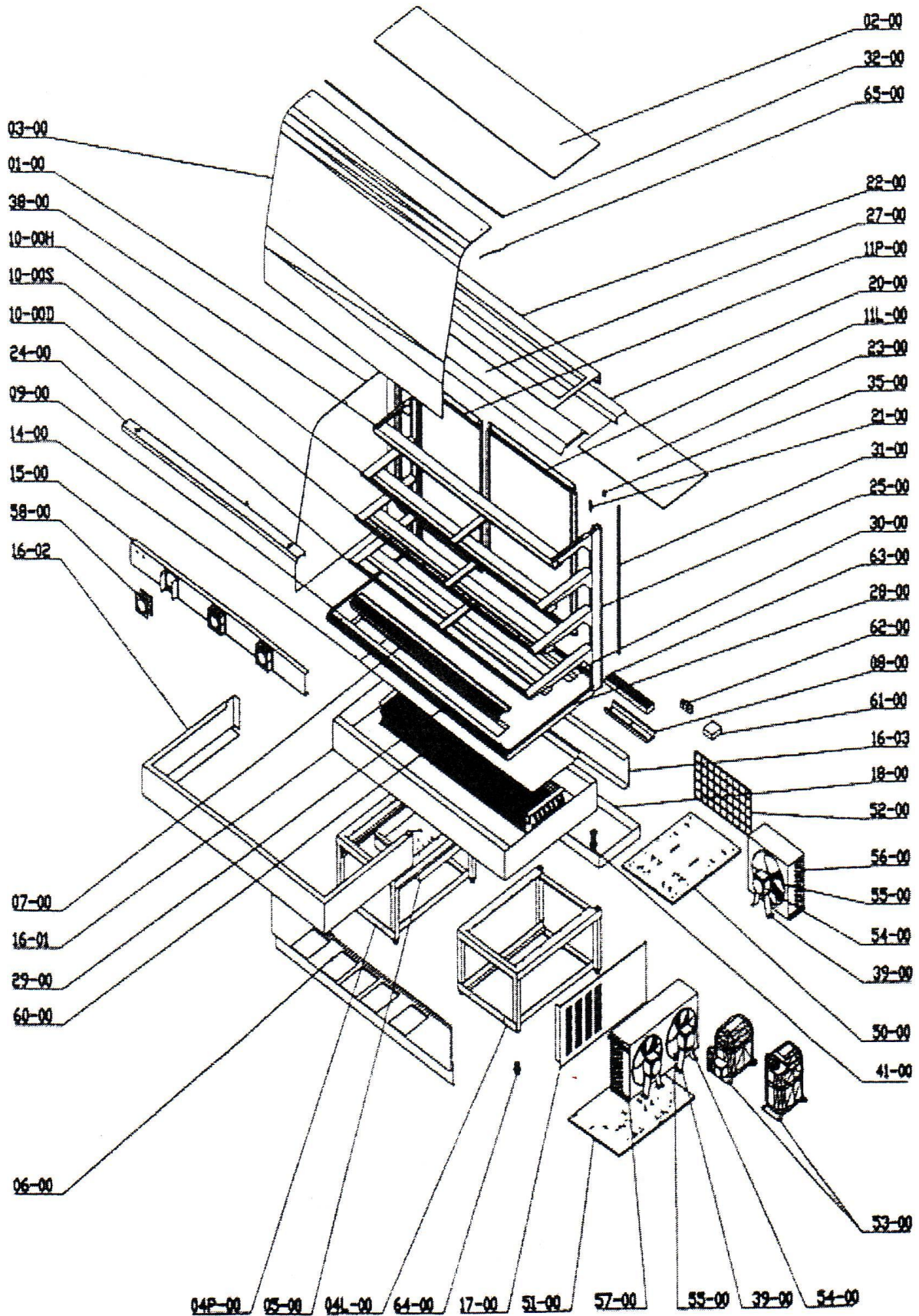

COOLING SHOWCASE 150

List of Spare Parts

01-00	Side glass
02-00	Top glass
03-00	Front glass
04-00	Base (welded)
05-00	Drawer (welded)
06-00	Decorative covering (set)
07-00	Front ventilation louver (welded)
08-00	Honeycomb holder
09-00	Display plate (set)
10-00H	Top shelf (mounting set)
10-00S	Middle shelf (mounting set)
10-00D	Low shelf (mounting set)
11L-00	Sliding doors – left (mounting set)
11P-00	Sliding doors – right (mounting set)
14-00	Evaporator cover
15-00	Fan panel sheet (set)
16-01	Insulated base (set)
16-02	Front base plate
16-03	Back base plate
17-00	Side plate
18-00	Draining tray
20-00	Top slide rail for doors (set)
21-00	Distance bracket
22-00	Top frame
23-00	Glass shelf plate
24-00	Support plate for lighting
25-00	AL – profile
27-00	Moulder for air circulation
28-00	Side glass strip
29-00	Front glass strip
30-00	Low slide rail for doors
31-00	Sliding doors sealing profile (gasket)
32-00	Front glass fuse profile
35-00	Shelf holder
38-00	Top frame console
39-00	Fan holder/ON-39/
41-00	Draining threaded joint
50-00	Compressor chassis
51-00	Compressor chassis – trophy version/GE-41/
52-00	Covering fan grid/IL-52/
53-00	Compressor GP18 TB or GB34 TB (trophy version)
54-00	Condenser fan motor
55-00	Condenser fan blade
56-00	Condenser
58-00	Evaporator fan (90mm)

60-00	Evaporator/1500
61-00	Electronic control unit
62-00	Function and lighting ON/OFF switch+power supply pilot light
63-00	PVC honeycomb
64-00	Rectifier stop-gap ending

Spares needed for 100 and 150 Showcase

Description	Code No.	100	150	Depends on
Side glass	01-00	2	2	*colour
Top glass	02-00	1	1	*colour, length
Front glass	03-00	1	1	*colour, length
Base (welded)	04-00	1	1	Length
Drawer (welded)	05-00	1	1	
Decorative covering (set)	06-00	1	1	Colour, length
Front ventilation louver	07-00	1	1	Length
Honeycomb holer	08-00	1	1	
Display plate (set)	09-00	1	1	Colour, length
Top shelf (mounting set)	10-00H	1	1	Colour, length
Middle shelf (mounting set)	10-00S	1	1	Colour, length
Low shelf (mounting set)	10-00D	1	1	Colour, length
Sliding door – left (set)	11L-00	1	1	Colour, length
Sliding door – right (set)	11P-00	1	1	Colour, length
Evaporator cover	14-00	1	1	
Fan panel sheet (set)	15-00	1	1	
Insulated base (set)	16-01	1	1	Length
Front base plate	16-02	1	1	Length
Back base plate	16-03	1	1	Length
Side plate	17-00	1	1	
Draining tray	18-00	1	1	
Top slide rail for doors (set)	20-00	1	1	Length
Distance bracket	21-00	1	1	
Top frame	22-00	1	1	Length
Glass shelf plate	23-00	1	1	Length
Support plate for lighting	24-00	1	1	Length
AL-profile	25-00	1	1	
Mouleder of air circulation	27-00	1	1	Length
Side glass strip	28-00	1	1	Colour
Front glass strip	29-00	1	1	Length
Low side rail for doors	30-00	1	1	Length
Sliding doors sealing profile (gasket)	31-00	2	2	Colour
Front glass fuse profile	32-00	1	1	Colour
Shelf holder	35-00	1	1	Shelves
Top frame console	38-00	1	1	Length
Fan holder/ON-39/	39-00	1	1	
Draining threaded joint (plastic)	41-00	1	1	
Compressor chassis	50-00	1	1	Length
Covering fan grid/IL-52/	52-00	1	1	
Compressor GP14TB or GB18TB (tropy version)	53-00	1	1	
Condenser fan motor	54-00	1	1	
Condenser fan blade	55-00	1	1	
Condenser	56-00	1	1	Length
Evaporator fan (90mm)	58-00	1	1	
Evaporator	60-00	1	1	Length

Electronic control unit	61-00	1	1	
Light switch+supply control light	62-00	1	1	
PVC honeycomb	63-00	1	1	
Rectifier stop-gap ending	64-00	1	1	

**!ALLWAYS note which Showcase you have
(high, with sliding doors, standard or with other specification)**

Page 11 of 11

1000/1500

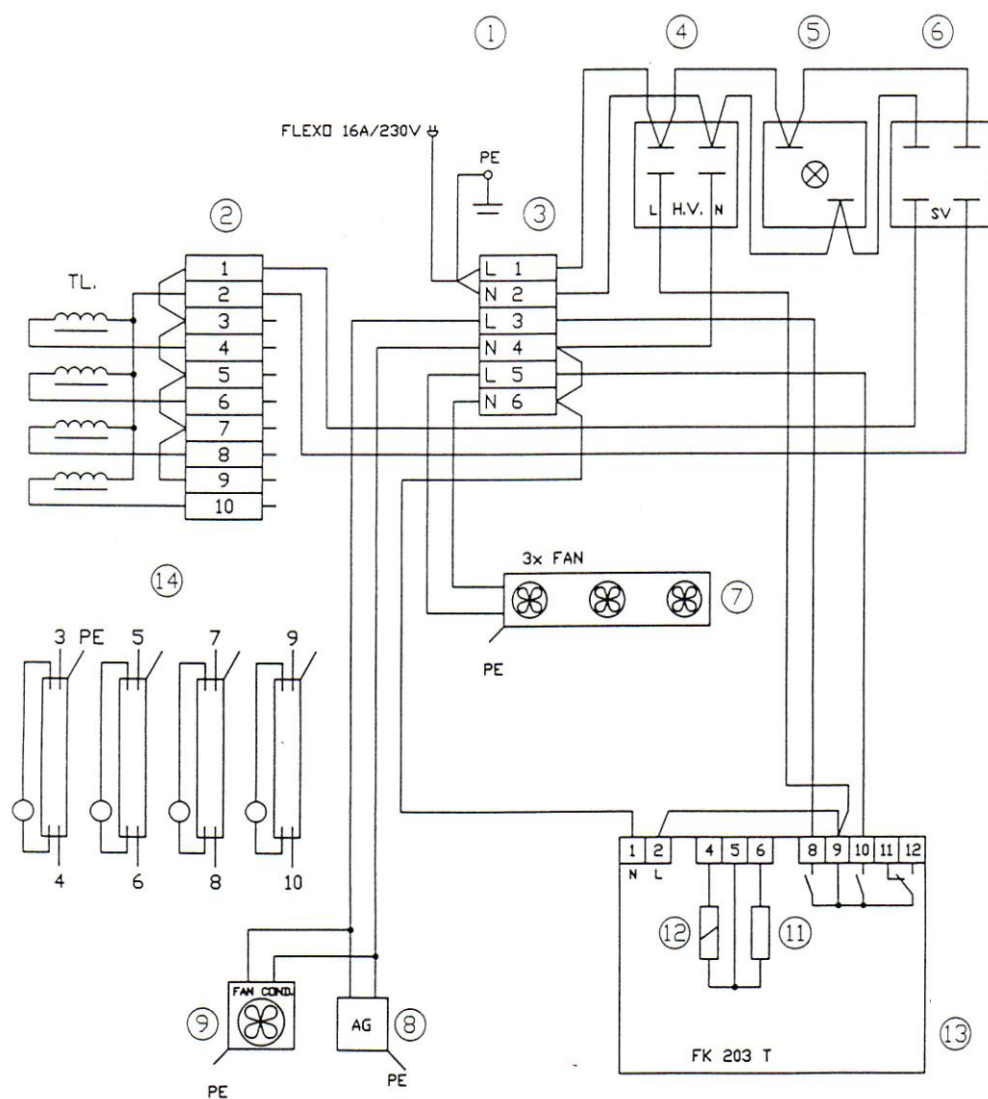

- | | |
|----------------------------|---------------------------------|
| 1. - FLEXOŠŇŮRA | 8. - AGREGÁT |
| 2. - SVORKOVNICE TLUMIVEK | 9. - VENTILÁTOR KONDENZÁTORU |
| 3. - HLAVNÍ SVORKOVNICE | 11. - ČIDLO VÝPARNÍKU (5-6) |
| 4. - HLAVNÍ VYPÍNAČ | 12. - ČIDLO CHL. PROSTORU (4-5) |
| 5. - KONTROLKA NAPÁJENÍ | 13. - ŘÍDICÍ JEDNOTKA REK 33 |
| 6. - VYPÍNAČ SVĚTEL | 14. - ZÁŘIVKY |
| 7. - VENTILÁTORY VÝPARNÍKU | |