

The power of simple. Multiplied.

The New Classeq Pass Through range.



CP500

Bringing simplicity to high-volume warewashing

The new CP500 Pass Through range delivers more innovation, more performance, and more simplicity where it matters most. All the features you need. None of the hassle you don't.



Simple choice.

Select an integrated water softener and/or steam recovery unit as required. Choose your power level - single phase, 30 Amp or three phase, 12, 16 or 22 Amp.

New for the CP500 both the 12 and 16 Amp, three phase models can be converted on site to 30 Amp, single phase.



Simple set up and configuration.

New packaging makes one person installation simple*. Commissioned on install as a dishwasher or glasswasher.

Easily configured for straight through or corner locations.



Simple use.

Press on. Simply close the hood to start a wash. Watch the display for notifications and troubleshooting.

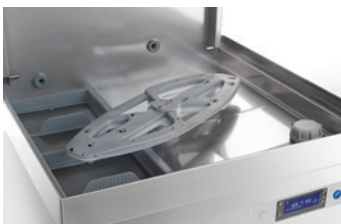

Simple cleaning.

New click-in, click-out wash arms, a double filtration system, deep clean programme and refresh cycle, all work together to make cleaning quick, easy, and hassle-free.



Simple app.

The Bluetooth® app gives operators and service technicians instant access to user guides, machine settings, performance data, and service info.



Simple servicing.

Quick access to key parts makes maintenance faster and more cost-effective.

Shared components with the undercounter range mean fewer spares and simpler servicing.

Simple. Robust.
CLASSEQ

* Installation must be carried out by a trained professional.
One person installation not applicable for models with steam recovery unit.

New Steam Recovery Unit















Our new steam recovery option minimises the steam released into the kitchen, eliminating the need for extraction and creating a more comfortable workspace.

Better still, the captured heat is reused to preheat incoming water, improving efficiency with every cycle.



Simple to use, clean and maintain,
robust enough to keep service
flowing day after day.

Standard features across the range –

-  Updated colour coded display.
-  Drain pump, rinse booster pump, detergent and rinse aid pumps all fitted as standard.
-  New energy saving standby mode.
-  New Bluetooth® app.
-  New deep clean programme and refresh cycle.
-  New utensil wash programme with optional basket for Gastronorm 1/1 trays.
-  New guided descaling programme.
-  New optional audible alarm.
-  New hygiene and service reminders.
-  New Rental Mode allowing Distributors to rent machines to operators based on number of wash cycles.
-  NEW optional chemical lance kit enabling the display of low detergent and low rinse aid warnings.
-  Range of tableting available, including support for bespoke requirements.
-  WRAS Compliant - Type AB air gap.
-  Four power options - single phase, 30 Amp or three phase, 12, 16 or 22 Amp. On site flexibility to convert 12 and 16 Amp three phase models to 30Amp, single phase.



Scan for more
information.

The details.

CP500

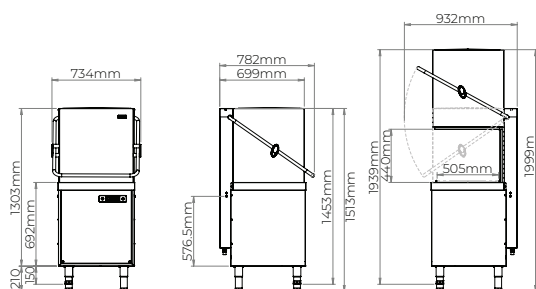

Capacities & Performance

	Dishwasher	Glasswasher
Rack/Basket Capacity	18 plates	25 glasses
Wash Programmes	1.5, 3, 5 & 7 min. cycles	1.5 & 2 min. cycles
Theoretical max racks per hour	40	40
Wash temperature	60°C	60°C
Rinse temperature	82°C (85°C on utensil wash programme)	70°C

Water supply connection	3/4"
Required water pressure	2.0 bar
Required water flow rate	4 litres/min
Drain size	Ø40mm
Drain height – Floor Level	0-700mm
Wash pump size	0.45kW
Wash tank Capacity	30 Litres
Wash tank heating	2kW
Rinse Boiler capacity	9 Litres (12 Litres for Intensive Models)
Rinse water Consumption at 2 bar	3.0 Ltrs
IP Rating	IP X4
Operating noise level	<70db

Components

WRAS Compliant - Type AB air gap	✓
Rinse booster pump	✓
Built in detergent dispenser	✓
Built in rinse aid dispenser	✓
Drain pump	✓
Temperature interlock	✓
Integrated Water Softener	Optional

CP500 (with optional Steam Recovery Unit)

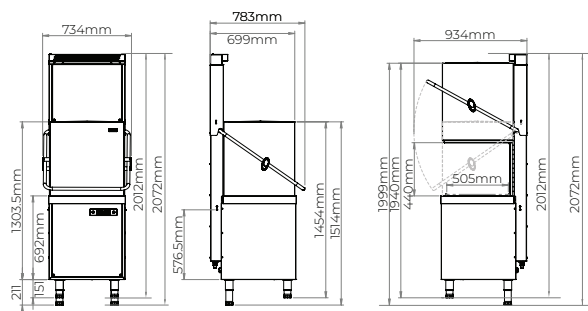

Weights

Net weight	130 Kg
Net weight – with Steam Recovery Unit	160 Kg
Weight (fully loaded)	170 Kg (173 Kg for Intensive Models)
Weight (fully loaded) – with Steam Recovery Unit	200 Kg (203 Kg for Intensive Models)

Electrical specification

Everyday Use	Single Phase	Three Phase
Amps required	30A	12A
Standard operating voltage	220-240V/1N~/50Hz	380-415V/3N~/50Hz
Total connected load	6.5 kW	6.5 kW
Intermediate Use		
Amps required	-	16A
Standard Operating Voltage	-	380-415V/3N~/50Hz
Total Connected Load	-	9.5 kW
Intensive Use		
Amps required	-	22A
Standard Operating Voltage	-	380-415V/3N~/50Hz
Total Connected Load	-	12.5 kW

Simple. Robust.
CLASSEQ



Tel: +44 (0)1889 272338 | classeq.co.uk

Scan to download the Classeq App for performance insights and useful guides.