

# Slim-line Stainless Steel Counters

600mm Depth



HBC2SL



LBC3SL



HBC4SL

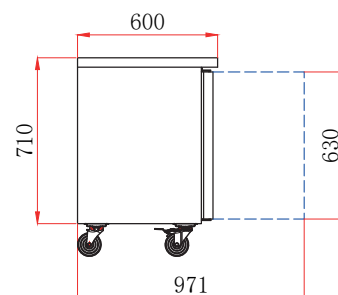

## FEATURES

- Stainless steel exterior & interior
- Even air distribution by ducted system
- 1x adjustable shelf per door (size - 330 x 430 mm)
- Heavy duty castors as standard
- Internal corners rounded for easy cleaning
- Self closing doors with dwell position
- Replaceable door gasket

## TECHNICAL SPECIFICATIONS

	HBC models	LBC models
Controller:	Dixell controller	
Cooling:	Ventilated	
Defrost:	Automatic	
Refrigerant:	R290	
Climate Class:	4	
Temperature Range:	+2°C ~ +8°C	-18°C ~ -22°C
Power Supply:	13amp	

MODEL	GROSS CAPACITY	EXT. DIMENSIONS (H x W x D mm)	ENERGY RATING	POWER CONSUMPTION	KWH /ANNUM	DECIBELS	WEIGHT (kg)	RRP
HBC2SL	228L	850 x 1360 x 600	C	220W	802	42dBA	109	
HBC3SL	339L	850 x 1795 x 600	C	230W	1214	42dBA	130	
HBC4SL	449L	850 x 2230 x 600	D	345W	1818	42dBA	160	
LBC2SL	228L	850 x 1360 x 600	E	520W	2762	42dBA	109	
LBC3SL	339L	850 x 1795 x 600	E	560W	3108	42dBA	129	
LBC4SL	449L	850 x 2230 x 600	E	650W	3673	42dBA	245	

